

RÜFÜS DU SOL

3 OCEANS WINERY – SATURDAY FEBRUARY 23 – 2019

We're pleased announce the return of **RÜFÜS DU SOL** to 3 Oceans Winery.

YES! We have implemented *WAY* more bar...cash and EFT bar

YES! We are offering **DOUBLE** the number of required toilets.

YES! We have done everything to mitigate the lines.

We're doing everything possible to make your concert experience the best it can be.

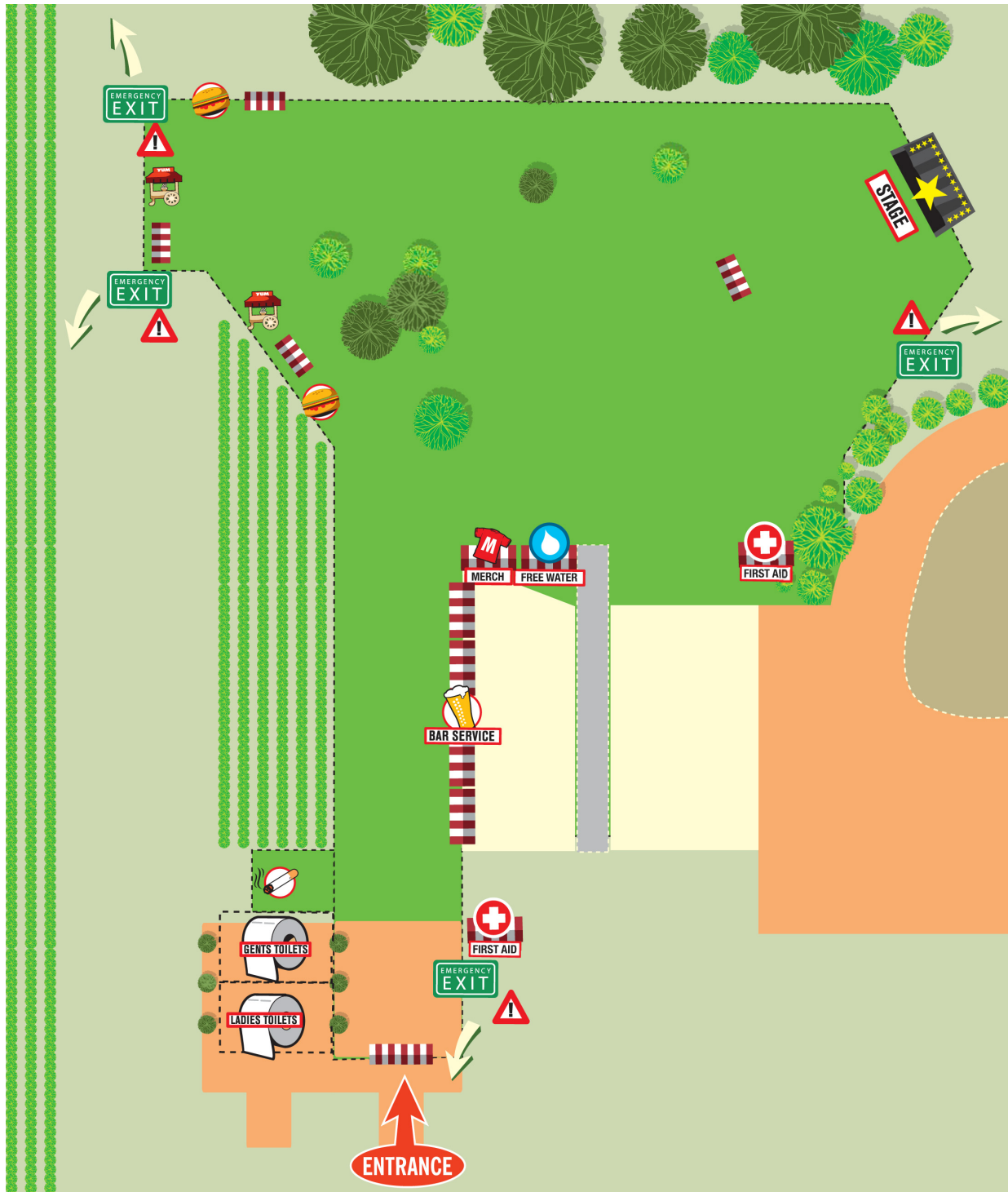

RÜFÜS DU SOL

3 OCEANS WINERY – SATURDAY FEBRUARY 23 – 2019

GETTING THERE

3 Oceans Winery is situated on Bussell Hwy in Metricup, which is almost exactly half way between Busselton & Margaret River. What a part of the world to be in!!

We have plenty of free parking at 3 Oceans Winery, but do encourage people to make use of the bus service offered by local company *Gannaway* from Busselton, Dunsborough & Margaret River.

You can get your bus tickets and all info at www.3oceansevents.com

If you do decide to drive, please see our lovely parking attendants upon your arrival for directions.

.....

FOOD & DRINK

It is a condition of the venue license that we cannot allow you to bring your own food and drink onto the site.

We have a sweet array of food vans which can cater for most dietary requirements.

You can view the food vans and their menus at the end of this document.

If you have a rare, legitimate condition that we're not catering for, please feel free to email us events@macromusic.com.au

We have free water on site so please feel free to bring an empty vessel to fill up at your leisure!

You can find the free water point on the site map on page 1!

We have a fully licensed bar which will be selling beer, wine, cider and some spirits at very reasonable prices!

If you're going to have a drink, why not make use of the buses!

.....

ACCESSIBILITY

The venue is fully accessible. Please get in touch with us at events@macromusic.com.au if you have a disability and require any assistance.

.....

SMOKERS

We have a designated space for you near the entry gates. Please respect others and keep your smoke to this area.

.....

WHAT TO BRING

- Your tickets! Remembering these will certainly start your day off on the right track!
- Your photo I.D is essential as this is a licensed, 18+ only event. Australian Drivers licence or passport will do the trick.
- Feel free to bring a small cushion if you would like a comfy bum, and for the comfort of others we only allow small, low-back, short legged folding chairs for pensioners and people with ACROD.
- Don't forget your empty water bottle.
- It's important to wear sensible shoes. We're down with sandals, but thongs & steel-cap boots are a no-no. We'd hate for you to step on something and hurt yourself.
- Of course, bring some cash or your card if you want to enjoy food, drink or score some sweet merchandise from the band.
- Remember to check the weather and bring appropriate clothing. It tends to get quite cold in the South West once the sun goes down!

Remember to bring everything you need with you, as we do not allow pass outs.

RÜFÜS DU SOL

3 OCEANS WINERY – SATURDAY FEBRUARY 23 – 2019

WHAT NOT TO BRING

- Bad energy! Leave it at home.
- Professional camera and recording equipment. By all means, bring your point and shoot cameras, but leave anything with a detachable lens at home.
- Weapons or anything that may be deemed unsafe by our lovely security personnel.
- Steel cap boots/shoes
- Food and drink; like we said before, we can't let it in!



TRASH & RECYCLING

You'll notice paired bins that are clearly marked around the site.

RECYCLING: please only place recyclable materials in these bins. It's a real bugger if they're contaminated.

WASTE: you can place things like food, perishables and any non-recyclable materials in these bins.

We're employing WASTE MARSHALLS to help reduce the waste at this show & we thank you for your contribution.



SHOW TIMES

Doors open: 6:00pm

Playing times tbc

Venue Close: 10:00pm



See over for the emergency exit plan.

RÜFÜS DU SOL

3 OCEANS WINERY – SATURDAY FEBRUARY 23 – 2019

KNOW YOUR EXITS

Please take a look at the below map outlining the EMERGENCY EXITS and the EMERGENCY MUSTER POINTS. It's best to familiarise yourself with these when you arrive at the site. In the rare case of an emergency, please walk calmly to an unobstructed EMERGENCY EXIT and follow the directions of the security personnel.

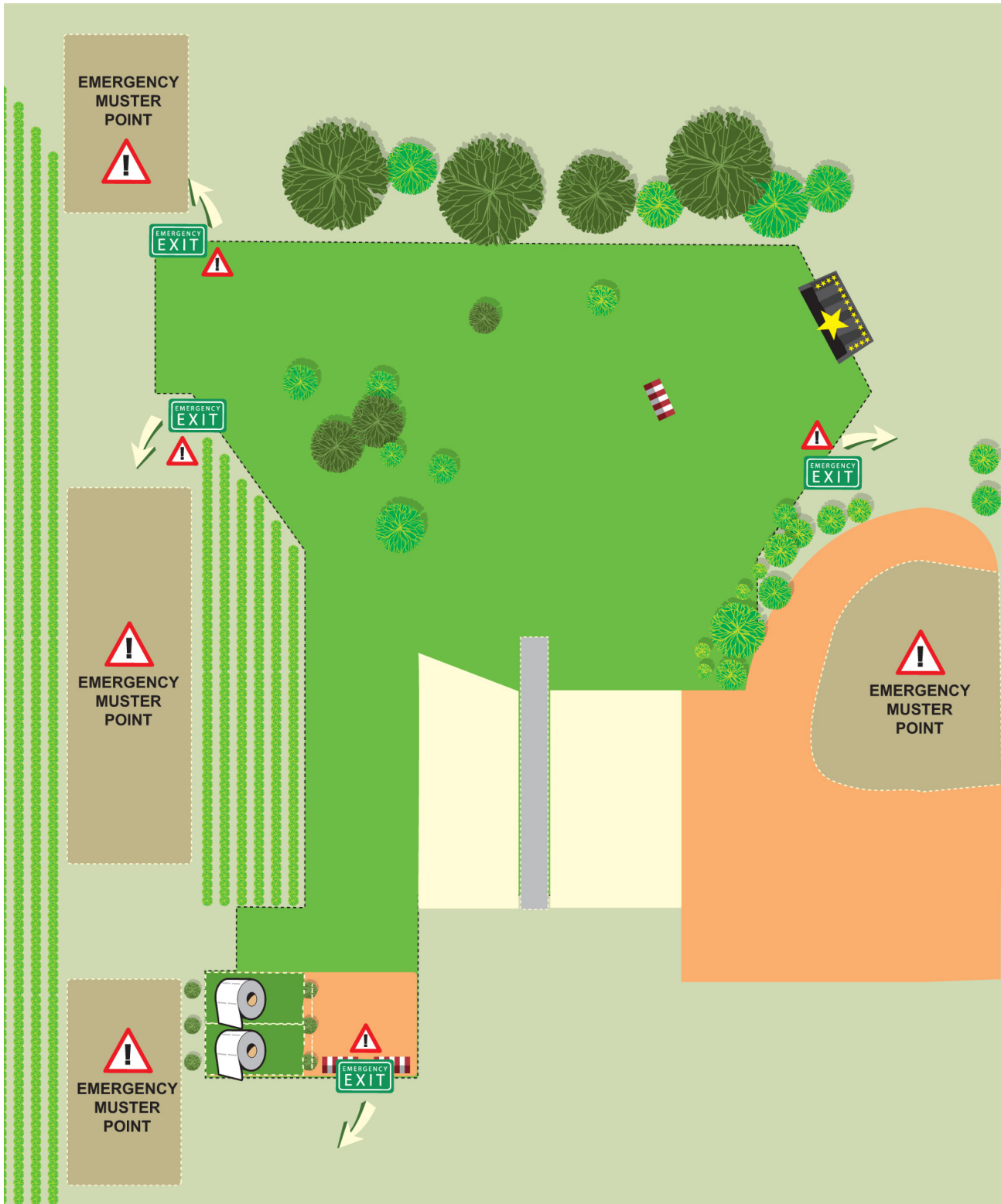

Here's wishing you all a great, fun and safe concert!